

DETAIL 01:
INDICATIVE SECTION: WOODLAND PLANTING TO BUND
 Scale 1:100 @ A1

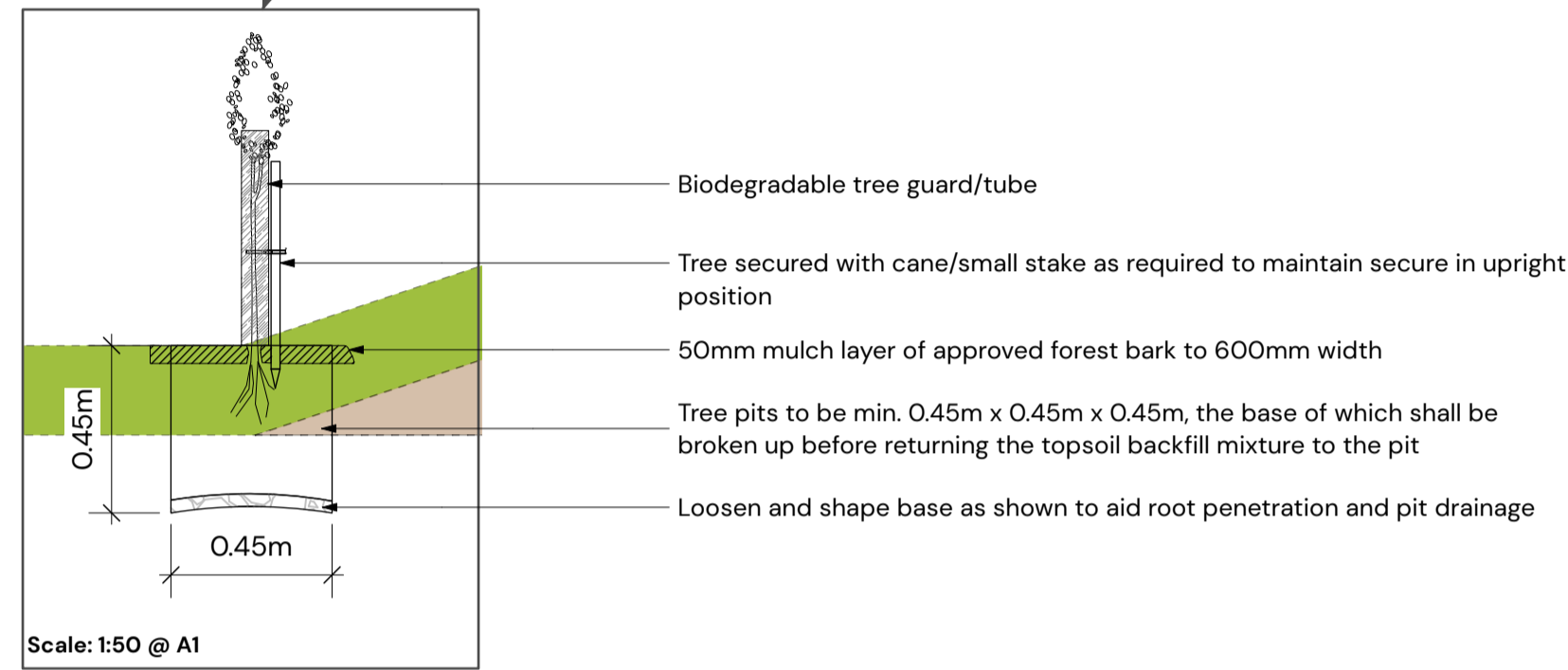
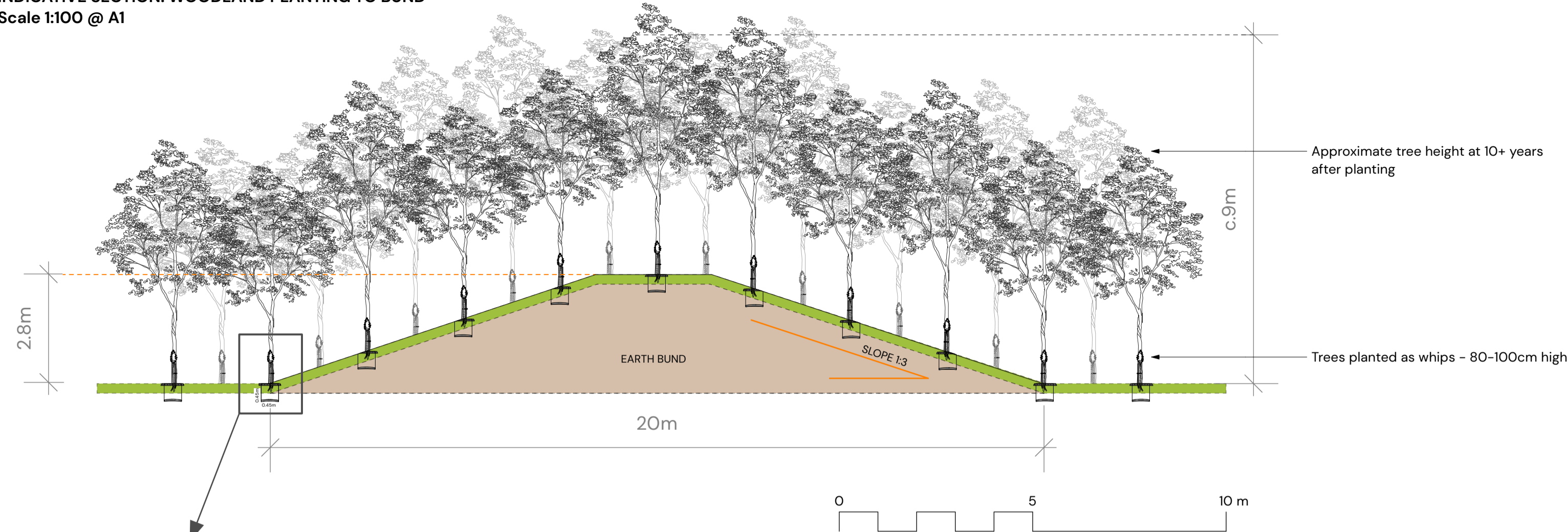

PLANTING SPECIFICATION: Woodland mix planting to bund

Topsoil

All soil is to be site topsoil, if imported topsoil is required, it must meet BS topsoil requirements for 'General Purpose' use.

Woodland mix

Individual pits shall be dug 450mm x 450mm x 300mm depth, the base of which shall be broken up before returning approved topsoil backfill mixture to the trench at the rate of one part compost to two parts topsoil.
 All stock shall be planted to the root collar and well firmed in place.
 After planting, a 50mm layer of approved forest bark shall be spread over each pit (600mm wide).
 On completion, all plants shall be thoroughly watered in.
 Each tree to be protected from rabbit damage by individual biodegradable spirals/tubes/tree guards.

Maintenance

Any trees that die, within a 5 year period of initial planting, shall be replaced with a plant of the same original specification.
 All trees shall be regularly checked and any broken ties, guards or stakes replaced, any loose trees should be reaffirmed and straightened where required.
 Mulch shall be topped up to maintain original levels.
 In periods of dry weather, where there has been no rainfall for 2 weeks, all year round, all trees shall be watered to field capacity on a weekly basis. This practice is to be maintained for at least 2 years after planting to aid establishment.
 Tree pits to be kept mulched to 50mm depth minimum and weed free.
 At the end of each growing season (i.e. November), all trees shall receive an application of slow release fertiliser.

After approximately 5 years, once the trees have established, stakes, ties and guards are to be removed and recycled.

The site shall be subject to a Landscape Management Plan, to be produced in conjunction with detailed landscape design. This shall contain management prescriptions for the site and will ensure successful establishment and ongoing health of tree planting. This shall include, but not be limited to, an annual inspection by landscape architect or arboricultural consultant to check health and establishment of trees, management prescriptions should then be reviewed and amended based on findings where necessary.

Refer to Site Layout Plan for location of palisade security fence and other boundary treatments within development area.

Refer to Sheet 1 for Landscape Masterplan

DETAIL 02:
TREE PROTECTION FENCING
 Scale: NTS

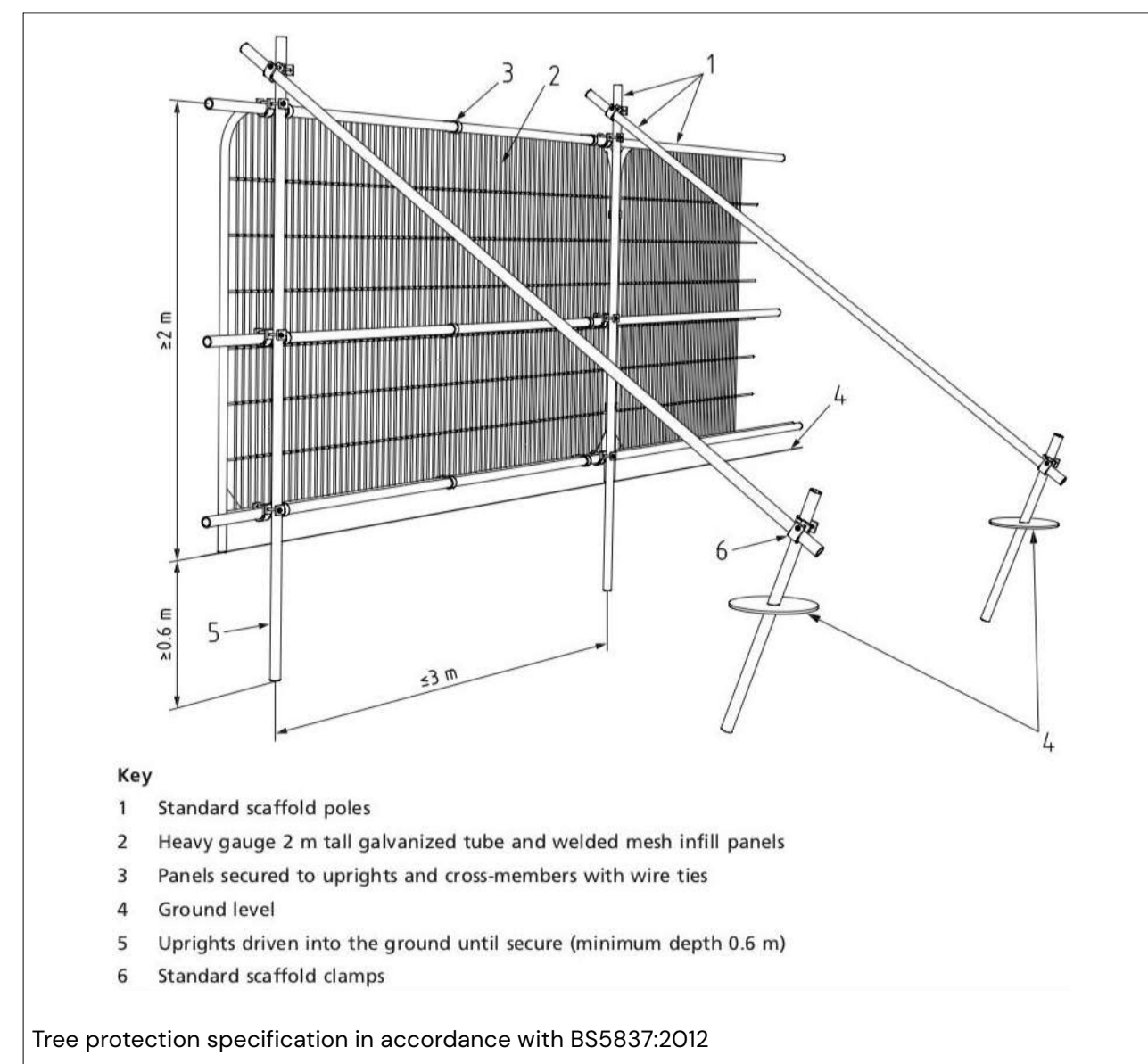
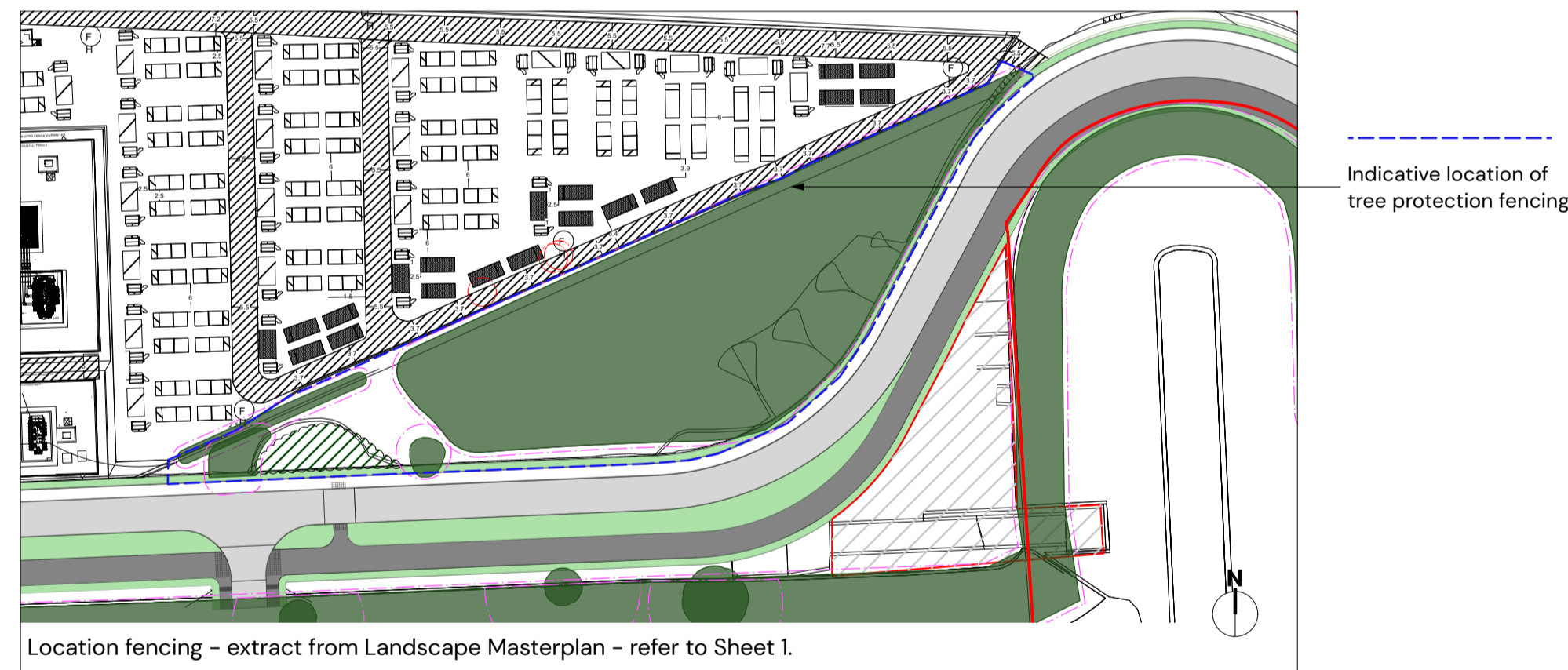

TREE PROTECTION FENCING

To be erected prior to start of any construction works
 To be erected in accordance with BS5837:2012
 Fencing specification as per Figure 2 of BS5837:2012
 To remain in situ until completion of all construction works

INDICATIVE PLANT SCHEDULE

TREES (Heavy Standards)		
Planted on a staggered grid, min. 3m centres in species groups of 3-5.		
Species	Size (girth & height)	%
Alnus glutinosa	12-14cm; 300-425cm ht; 3x; Heavy Standard; clear stem 175-200cm; 5	10
Betula pendula	12-14cm; 300-425cm ht; 3x; Heavy Standard; clear stem 175-200cm; 5	15
Betula pubescens	12-14cm; 300-425cm ht; 3x; Heavy Standard; clear stem 175-200cm; 5	15
Prunus avium	12-14cm; 300-425cm ht; 3x; Heavy Standard; clear stem 175-200cm; 5	15
Quercus robur	12-14cm; 300-425cm ht; 3x; Heavy Standard; clear stem 175-200cm; 5	10
Sorbus aria	12-14cm; 300-425cm ht; 3x; Heavy Standard; clear stem 175-200cm; 5	20
Sorbus aucuparia	12-14cm; 300-425cm ht; 3x; Heavy Standard; clear stem 175-200cm; 5	15

WOODLAND MIX		
Planted on a staggered grid, at 2.5m centres in species groups of 3-5.		
Species	Size	%
Betula pendula	B; 80-100cm ht; 1+1; Transplant - seed raised	15
Corylus avellana	B; 80-100cm ht; 1+2; Transplant - seed raised; branched; 4 breaks	25
Crataegus monogyna	B; 80-100cm ht; 1+2; Transplant - seed raised	15
Malus sylvestris	B; 80-100cm ht; 1+2; Transplant - seed raised	20
Prunus padus	B; 80-100cm ht; 1+1; Transplant - seed raised	10
Sorbus aucuparia	B; 80-100cm ht; 1+1; Transplant - seed raised	15

NATIVE MIXED HEDGEROWS (new sections and 'gapping up')		
Planted in double staggered row, 5 plants per liner metre, rows 500mm apart.		
Species	Size	%
Corylus avellana	B; 80-100cm ht; 1+2; Transplant - seed raised; branched; 4 breaks	20
Crataegus monogyna	B; 80-100cm ht; 1+2; Transplant - seed raised	50
Ilex aquifolium	RB; 80-100cm ht; leader with laterals	5
Prunus spinosa	B; 80-100cm ht; 1+2; Transplant - seed raised; branched; 3 breaks	20
Rosa canina	B; 60-80cm ht; 1+1; Transplant - seed raised; branched; 3 breaks	5

NATIVE HEDGEROW (southern boundary adjacent to footpath)		
Planted in single row, 5 plants per liner metre.		
Species	Size	%
Carpinus betulus	B; 80-100cm ht; 1+1; Transplant - seed raised	40
Corylus avellana	B; 80-100cm ht; 1+2; Transplant - seed raised; branched; 4 breaks	20
Ligustrum vulgare	B; 80-100cm ht; 0/2; Cutting; branched; 3 breaks	30
Viburnum opulus	B; 80-100cm ht; 1+2; Transplant - seed raised; branched; 3 breaks	10

Notes:

Proposed planting to comprise species of local provenance, with stock in accordance with seed zone 203 as described in Seed Sources for Planting Native Trees and Shrubs in Scotland (Forestry Commission Scotland 2006).
 Existing vegetation on site perimeter to be protected and retained as far as practicable in accordance with BS 5837:2012.
 All other planting to be 3m from existing and proposed features.
 Emergency and maintenance access will be from the west of the B1348 Edinburgh Road (via the existing access).
 Construction access will be taken from the south east off the B6371 via the existing access.

Rev	Date	By	Note
A	24/04/24	LB	Minor amendments to layout
-	19/06/24	LB	First issue S2

Landscape Masterplan
Cockenzie BESS
 Sheet 2 of 2

Client: Cockenzie Storage Ltd

DRWG No: P23-0093_EN_0002_S2 REV: -

Drawn by: LB Approved by: KC

Date: 19/06/2024

Scale: 1:1250 @ A1

